

**AS APPROVED BY
SELWYN DISTRICT COUNCIL
Planning Department**

**RESOURCE CONSENT
RC215346**

17/06/2021 robine

**AS APPROVED BY
SELWYN DISTRICT COUNCIL
Planning Department**

**RESOURCE CONSENT
205545**

16/12/2020 flynnr

1. These plans are subject to final survey and as shown on the plans.
2. Any easements to be created as required.
3. This plan has been prepared for discussion purposes only. No liability is accepted if the plan is used for any other purpose.
4. This plan has been prepared for the use of our client and no liability is accepted in relation to any other parties.
5. Any measurements taken from information which is not drawn on the electronic copy are at the risk of the recipient.
6. This plan is subject to the granting of subdivision and/or resource consent and should be treated as a proposal until such time as the necessary consents have been granted by the relevant authorities.
7. Consents shown are from Wood and Partners geographical survey.

Total Area: 8.0774Ha Comprised in: RTs: CB35D/381 & CB35C/801	For Discussion Purposes DATE: 11/25/2020 DRAWN BY: J13771488/Superv 37.dwg DRAWING NO:	SHEET NO: 1 TOTAL SHEETS: 7
Proposed Subdivision of RS 41727 & Lot 1 DP 61162		
493, 499 Springston Rolleston Road		
 Kim McCracken & Associates Resource Management Planning Consultants		

Urban Estates

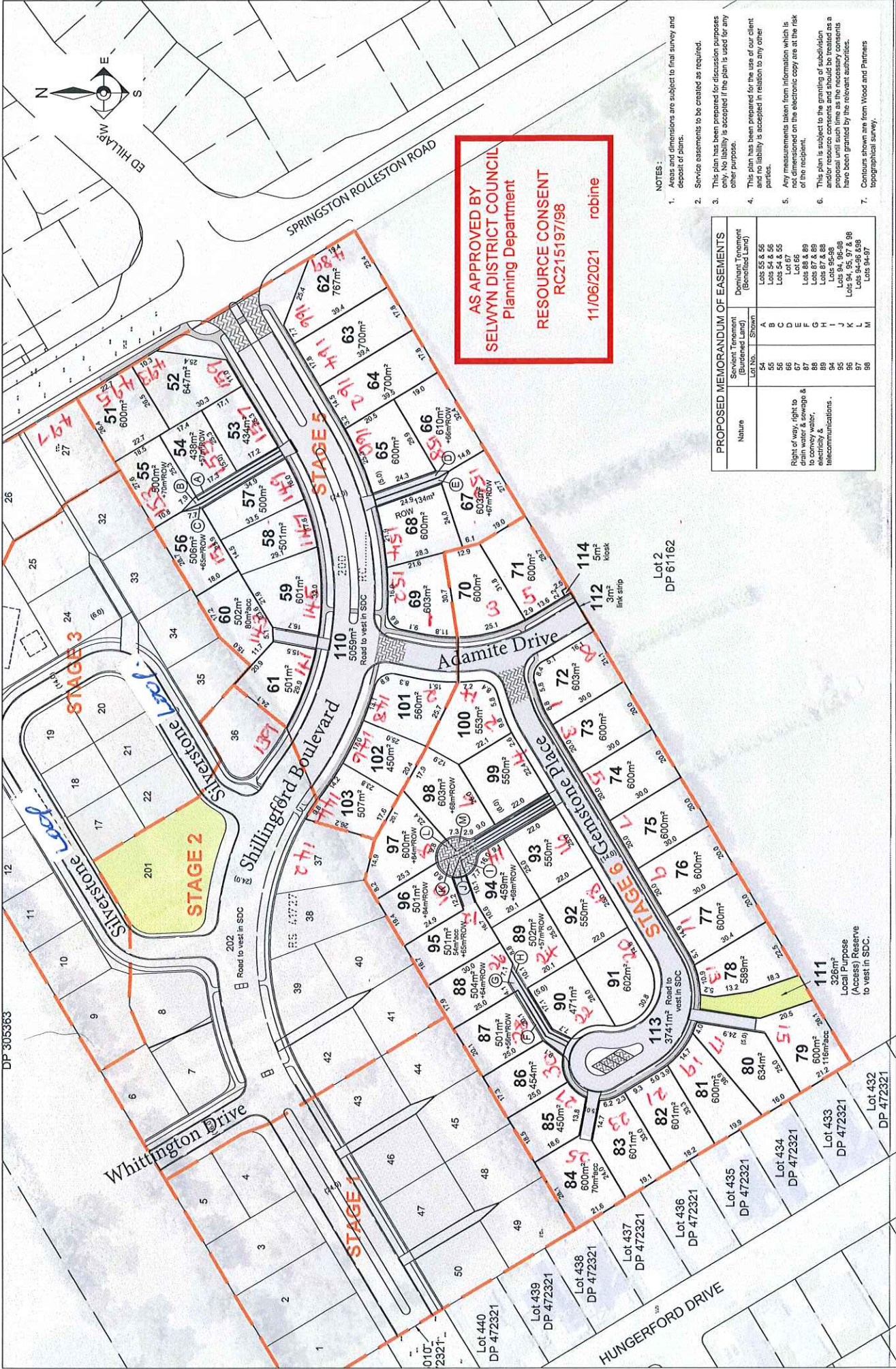

AS APPROVED BY
SELWYN DISTRICT COUNCIL
Planning Department
RESOURCE CONSENT
RC21519798
11/06/2021 **robine**

- NOTES :**
- Areas and dimensions are subject to final survey and deposit of plans.
 - Service easements to be created as required.
 - This plan has been prepared for discussion purposes only. No liability is accepted if the plan is used for any other purpose.
 - This plan has been prepared for the use of our client and no liability is accepted in relation to any other parties.
 - Any measurements taken from information which is not dimensioned on the electronic copy are at the risk of the recipient.
 - This plan is subject to the granting of subdivision and/or resource consents and should be treated as a proposal until such time as the necessary consents have been granted by the relevant authorities.
 - Contours shown are from Wood and Partners topographical survey.

PROPOSED MEMORANDUM OF EASEMENTS		
Nature	Servient Tenement (Burdened Land)	
Right of way, right to conveyance & to convey water, electricity & telecommunications.	Lot No. 54	Dominant Tenement (Benefitted Land)
	55	Lot 55 & 56
	56	Lot 54 & 55
	57	Lot 67
	58	Lot 66
	59	Lot 85 & 86
	60	Lot 87 & 88
	61	Lot 95-98
	62	Lot 94, 95, 97 & 98
	63	Lot 95-98
	64	Lot 95-98
	65	Lot 94-97

493, 499 Springston Rolleston Road

Proposed Subdivision of Lot 200 RC.....

SILVERSTONE OF URBAN ESTATES

Kim McCracken & Associates
Resource Management Planning Consultants

Total Area: 4.0162Ha
Comprised in: RT's: CB35D/381 & CB38C/604

For Discussion Purposes

SCALE: 1:1250@A3 DATE: June 2021

SHEET NO: 1 DRAWING NO: 1

VERSION: 6